

 **ITALIANA**<sup>®</sup>  
*ferramenta*

Liku



HANGERS



# SYMBOLS AND FINISHES LEGEND

## SYMBOLS



= SHELF SAFELY LOCKED DURING TRANSPORTATION AND AT HOME.



= ANTI-TURNOVER LOCKING SYSTEM



= NORMS / PATENTS



= PHILLIPS / POZIDRIV



= WITH BUFFER



= PART NO.



= BLADE SLOT



= WITH MAGNET



= PCS. PER PACKAGE



= COMBI SLOT



= HEXAGONAL SOCKET



= NEWTON



= CAPACITY LOADING



= HEXALOBULAR SOCKET



= FRICTION



= WOOD / GLASS THICKNESS



= COUNTERSUNK HEAD



= AUTOMATIC



= HOLE DIAMETER



= PAN HEAD



= DROP DOWN



= DIAMETER



= FLANGE HEAD



= LENGTH



= FLAT HEAD



= STANDARD HINGE



= HEIGHT



= TRILOBULAR SCREW



= KIMANA HINGE



= RIGHT VERSION



= SELF-TAPPING SCREW



= FLAP HINGE



= LEFT VERSION



= EURO THREAD



= WITH SPRING



= SETTING CODE



= METRIC THREAD



= WITHOUT SPRING



= PCS. PER PAD



= PRE-INSERTED SCREW



= REVERSED SPRING



= CUT ON REQUEST



= PRE-INSERTED SCREW AND SPREADING BUSH



= SELF ADHESIVE



= WITH FLANGE

NOTE: Printing errors and omissions may exist despite our best efforts to ensure accuracy. We reserve the right to alter specifications without notice.

## MATERIALS

**ZA** = Zinc Alloy

**ST** = Steel

**HSS** = High Speed Steel

**BR** = Brass

**ABS** = Acrylonitrile Butadiene Styrene

**ZAnk** = Nickel-plated Zinc Alloy

**STzk** = Zinc-plated Steel

**AL** = Aluminium

**WD** = Wood

**EVA** = Ethylene Vinyl Acetate

**EP** = **ENGINEERING PLASTIC**

+ **EP** = other engineering plastic available on request

**SR** = **SOFT RUBBER**

+ **SR** = other soft rubber available on request

**EPn** = Natural Engineering Plastic

**EPc** = Clear Engineering Plastic

**SRn** = Natural Soft Rubber

**EPw** = White Engineering Plastic

**EPg** = Grey Engineering Plastic

**SRw** = White Soft Rubber

**EPwg** = Water Green Engineering Plastic

**SRb** = Black Soft Rubber



## FINISHES



= OTHER FINISHES AVAILABLE ON REQUEST

PART NO.	FINISHES	PART NO.	FINISHES	PART NO.	FINISHES
<b>00</b>	Insignificant finish	<b>IF</b>	Middle Grey	<b>UT</b>	T-Met 9007
<b>AA</b>	Natural	<b>IJ</b>	Light Grey	<b>UZ</b>	T-Met
<b>AB</b>	White	<b>IL</b>	Grey 20	<b>WA</b>	Bronzed
<b>AE</b>	White 9010	<b>IN</b>	Grey met. 26	<b>WI</b>	Burnished
<b>EA</b>	Black	<b>JB</b>	Bright Aluminium	<b>XD</b>	Satin-finished Steel
<b>EC</b>	Matt Black	<b>JC</b>	Aluminium - Chrome	<b>YA</b>	Nickel-plated
<b>EE</b>	Anthracite	<b>JD</b>	Matt Aluminium	<b>YB</b>	Bright Nickel-plated
<b>EW</b>	Grey 9007	<b>JE</b>	Satin-finished Aluminium	<b>YC</b>	Matt Nickel-plated
<b>FU</b>	Gunmetal	<b>JF</b>	Aluminium - Brass	<b>YD</b>	Satin-finished Nickel-plated
<b>FV</b>	Gunmetal V52	<b>JG</b>	Aluminium 5	<b>YQ</b>	Black Nickel
<b>GR</b>	Raw	<b>JL</b>	Aluminium PE 11	<b>Z9</b>	Black Zinc
<b>HA</b>	Brass-Plated	<b>JM</b>	Aluminium RAL 9006	<b>ZA</b>	Zinc alloy
<b>HH</b>	Tropicalized	<b>KA</b>	Chrome	<b>ZN</b>	Zinc-plated
<b>HL</b>	Raw Brass	<b>KB</b>	Bright Chrome	<b>ZQ</b>	Bright Gold
<b>HX</b>	Graphite	<b>KC</b>	Matt Chrome	<b>ZY</b>	Titanium
<b>IA</b>	Grey	<b>NN</b>	Metallic Beige	<b>ZZ</b>	Clear
<b>IB</b>	Metallic Grey	<b>RO</b>	Red		

LIKU

LIKU is the concealed hanger conceived to fix suspended libraries and cabinets to the wall even when their structure is conceived without the back panel.

LIKU is to be inserted into the side of the furniture and can be used with panels minimum 25mm thick.

LIKU, conceived to sustain very heavy pieces of furniture with very heavy loads, has a capacity loading of 250 kg per piece.

This is made possible by:

- The double hanging-hook which allows a uniformly distributed load on the wall bracket.
- The optimized shape of the wall bracket which reduces the stress on the rawl plugs.
- The robust and compact body of the system.

LIKU is a very safe system as it is provided with a self-inserting anti-turnover device.

Provided with 3 independent adjustments

- Horizontal: 13 mm (the only available on the market)
- Vertical: 15 mm
- Sideways: 9 mm (6 on the wall bracket; 3 on the hanger)

In combination with Rekord 14 leveller it is possible to adjust the inclination of the cabinet.



interzum award:  
intelligent  
material & design  
2011



250 Kg per piece



25 mm min.



**INSTALLATION: LIKU AND LEVELLER  
Ø 14 H. 52 INSTALLATION**

recommended fixing pan head  
wood screws Ø 4x60 mm

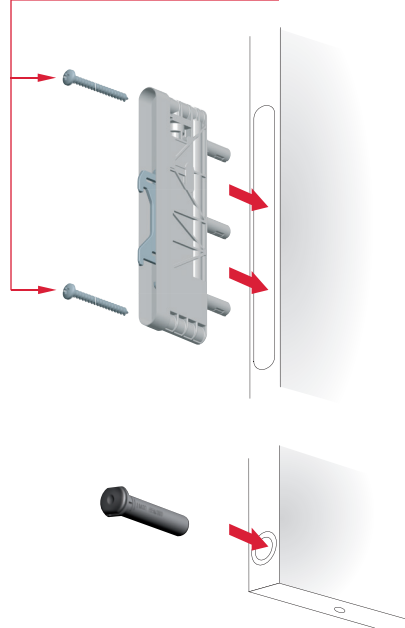

**WALL PLATE FIXING AND LATERAL  
ADJUSTMENT - 6 mm**

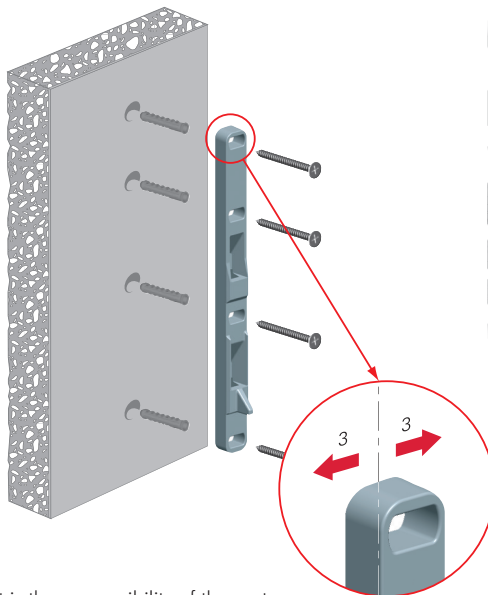

**INSTALLATION AND FURTHER LATERAL  
ADJUSTMENT - 3 mm**

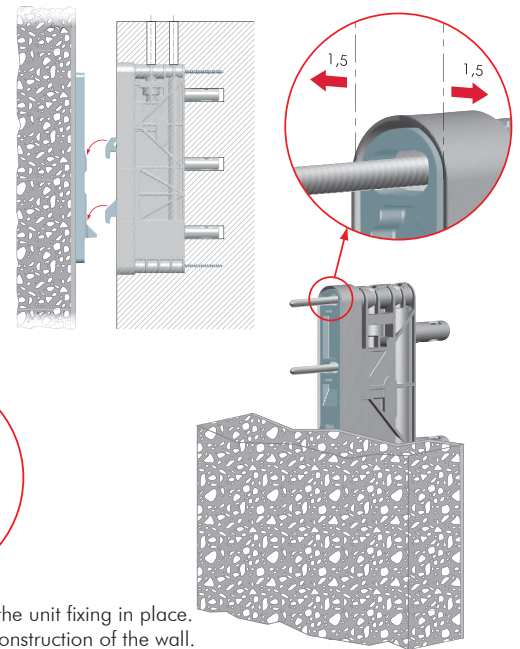

It is the responsibility of the customer:

- to ensure that the wall is of a suitable quality to hold the unit fixing in place.
- to use the proper hardware fittings according to the construction of the wall.

For more specific information, please refer to the WARNINGS section at the end of the catalogue.

**VERTICAL ADJUSTMENT - 15 mm**

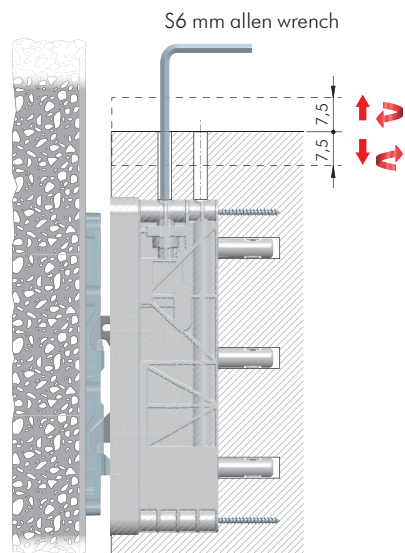

**IN-DEPTH ADJUSTMENT - 13 mm  
AND ANTI-TURNOVER SYSTEM**

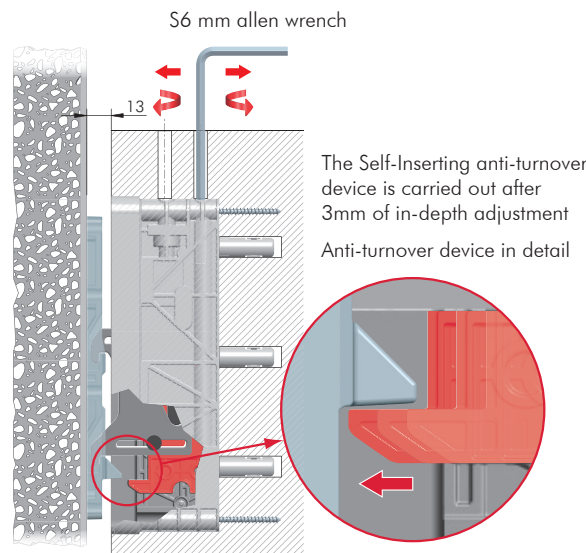

**INCLINATION ADJUSTMENT**

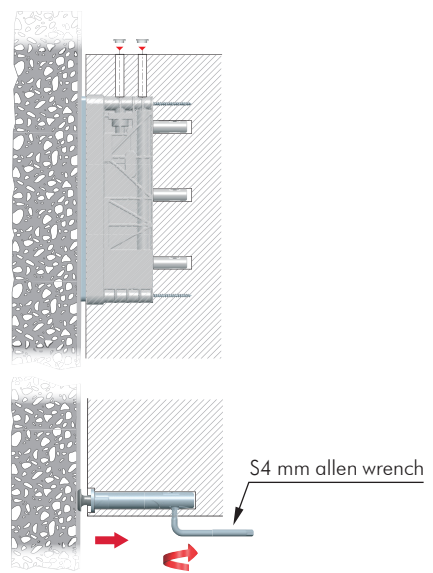

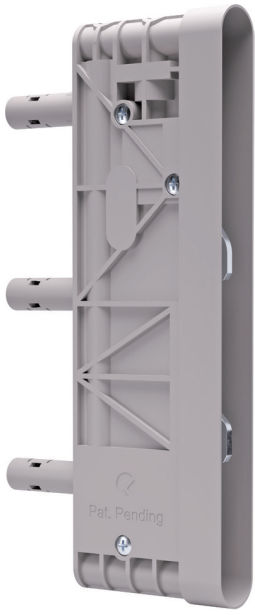

ZA	EP	ST	= 40 pcs.
<b>6380100000</b>			

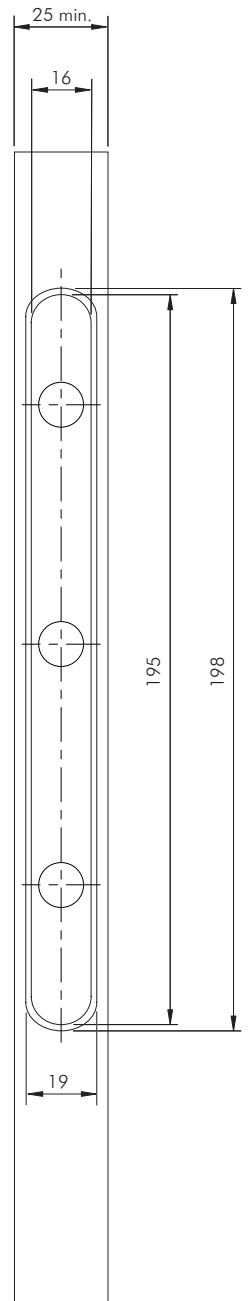
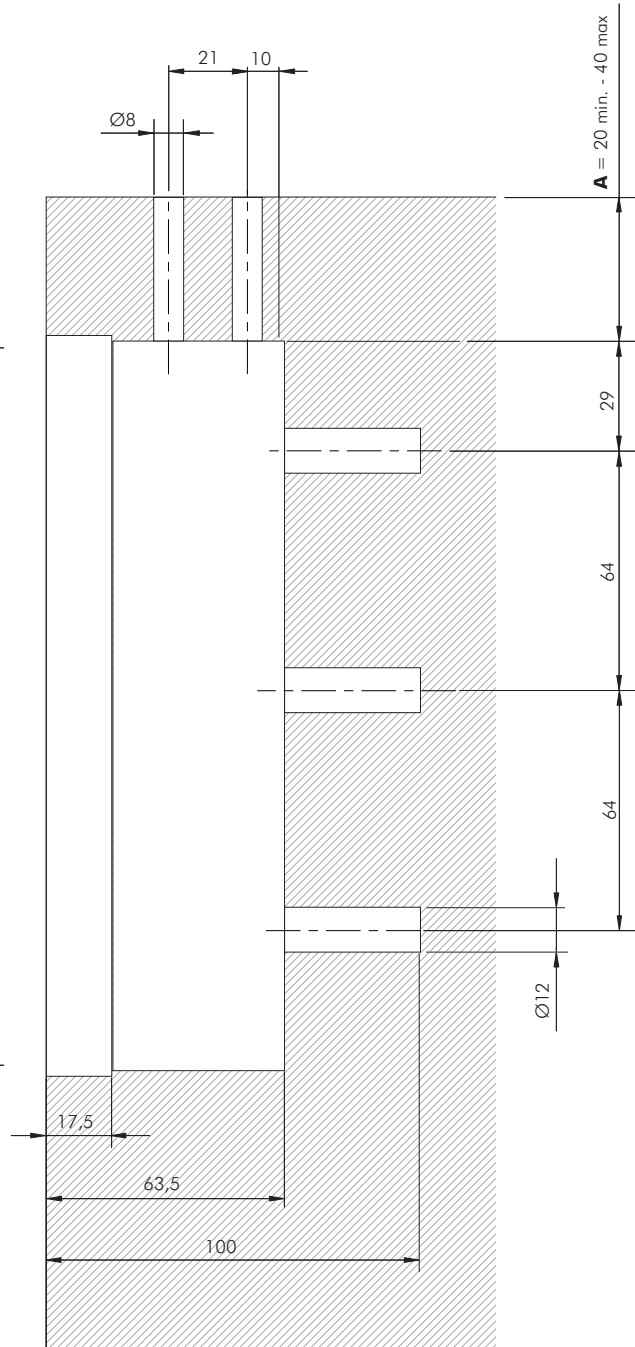
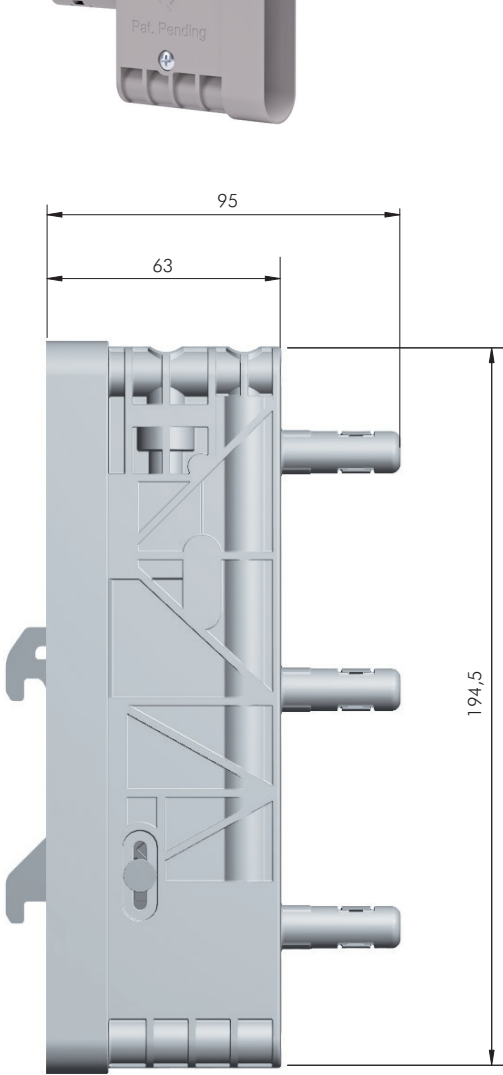

A = Distance from top edge

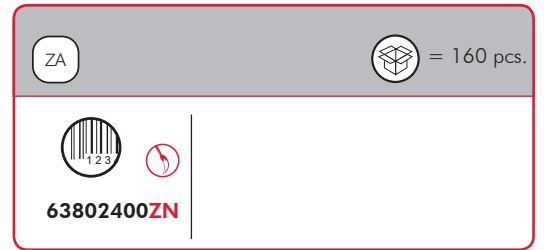
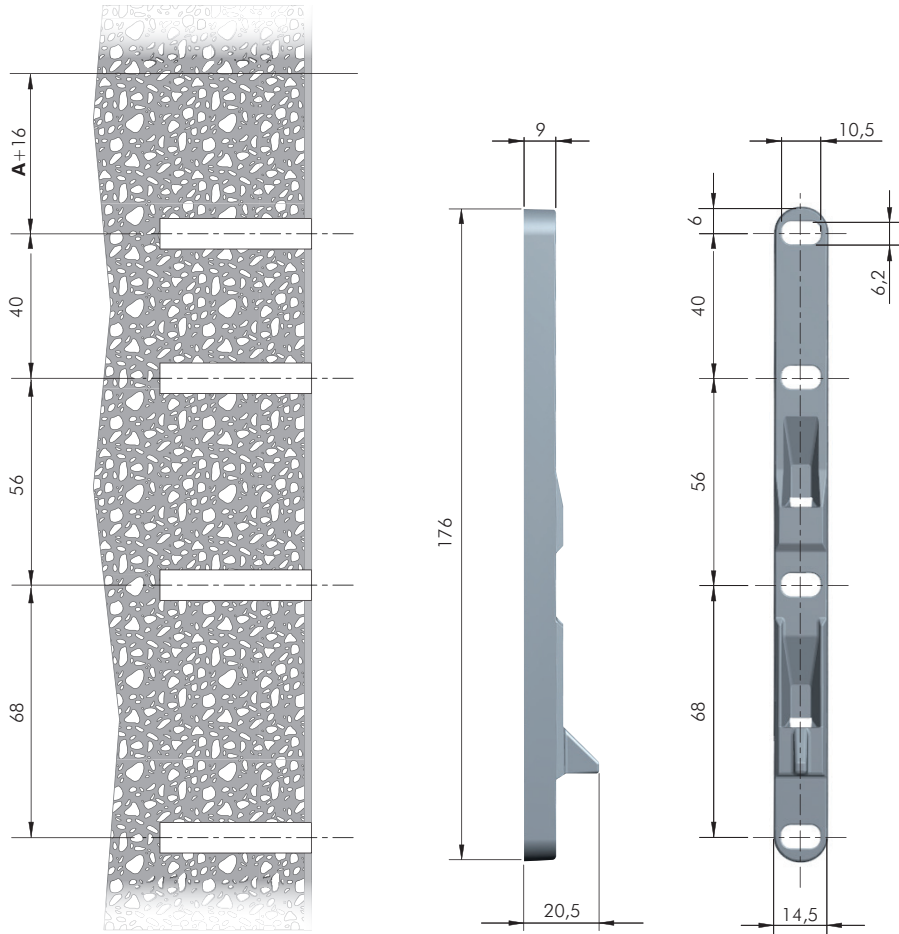

**LEVELLER Ø 14 H 52 mm**

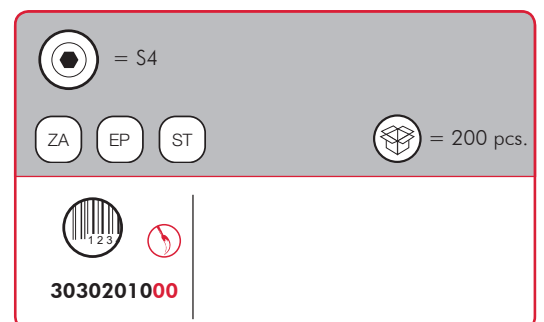
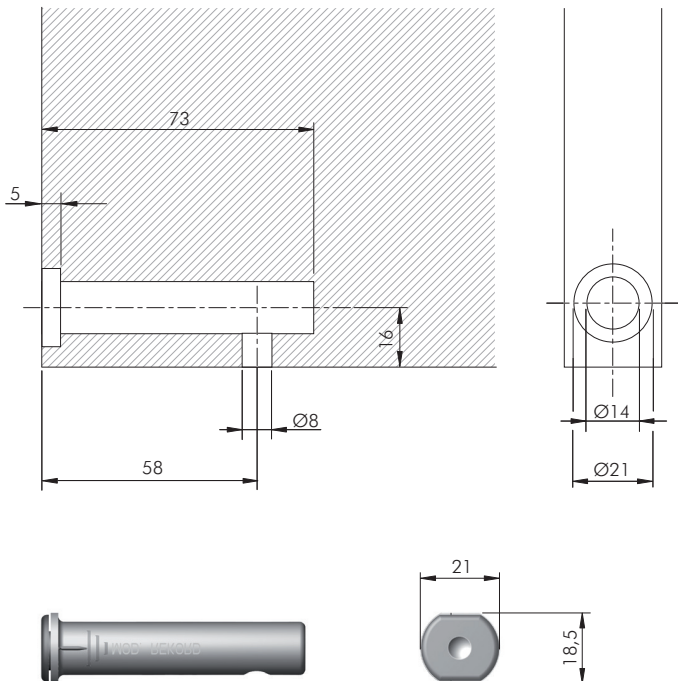

- For details refer to section "LEVELLER Ø 14"



**LIKU ACCESSORY**

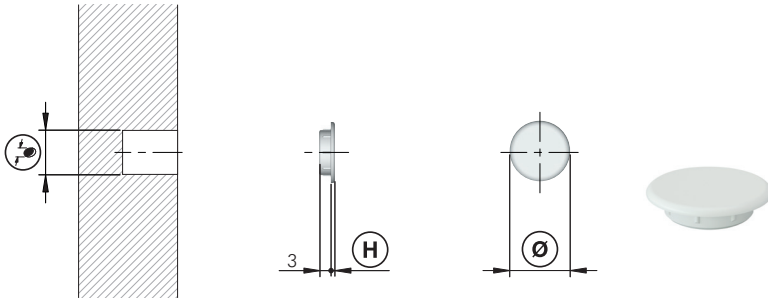

= Ø 8 mm		
EP		
123		Ø 8
<b>23002010AB</b>	Ø 11	H 1
		5000

**LIKU FIXING ACCESSORY**

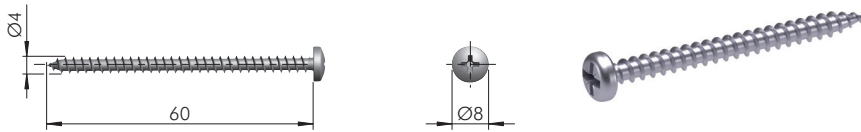

		= PZ2	
ST		= 200 pcs.	
123			
<b>60103350ZN</b>			

**DRILL BIT FOR LIKU**

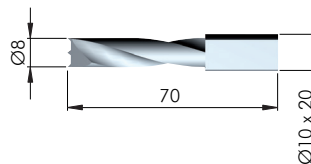
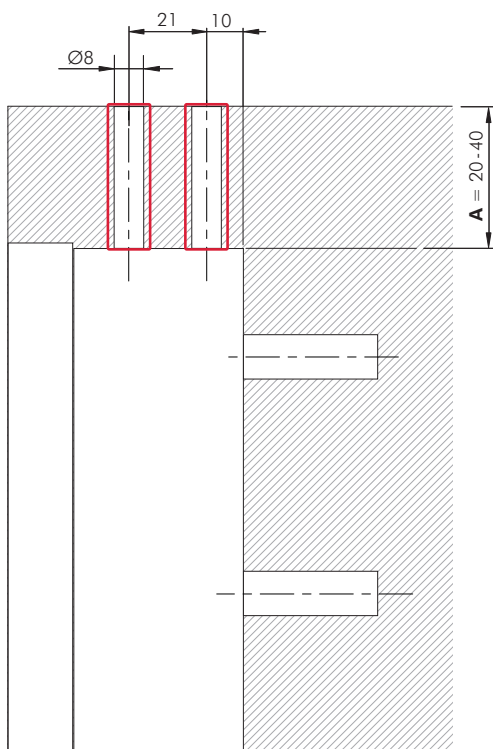

HSS	= on request
123	
<b>6380243000</b>	

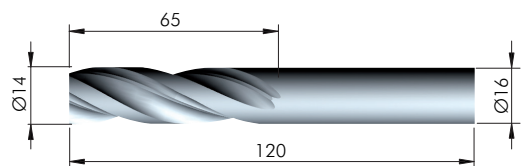
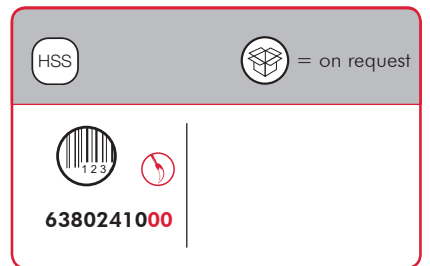
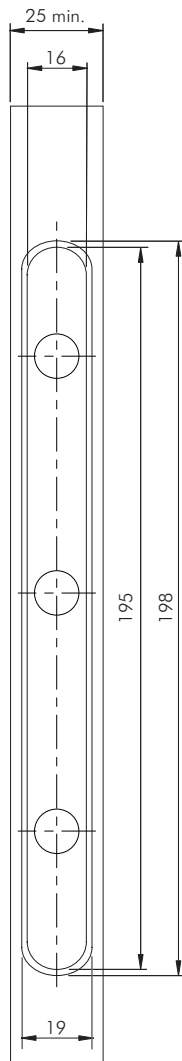
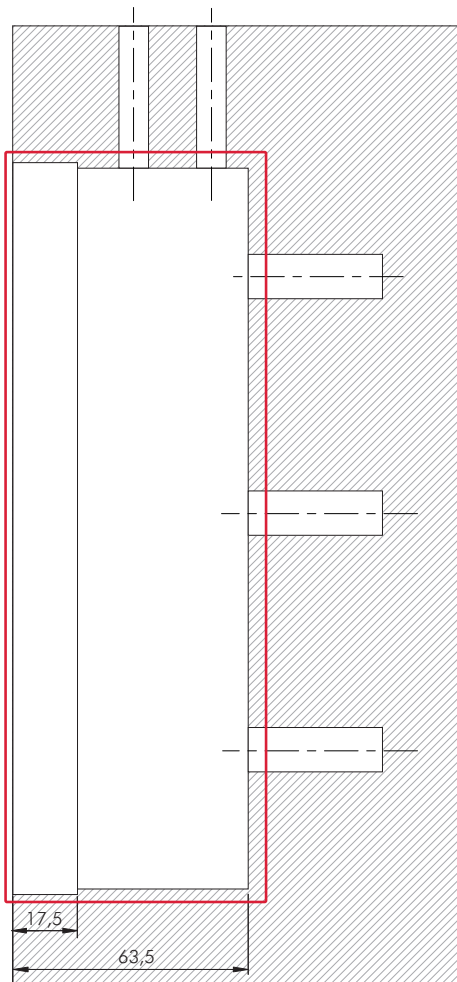
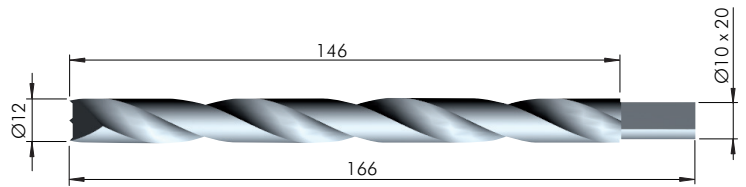
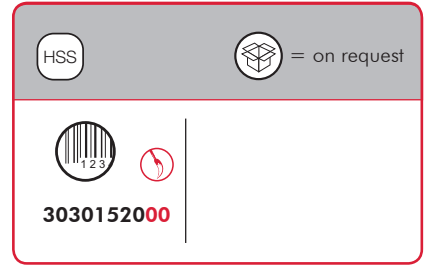
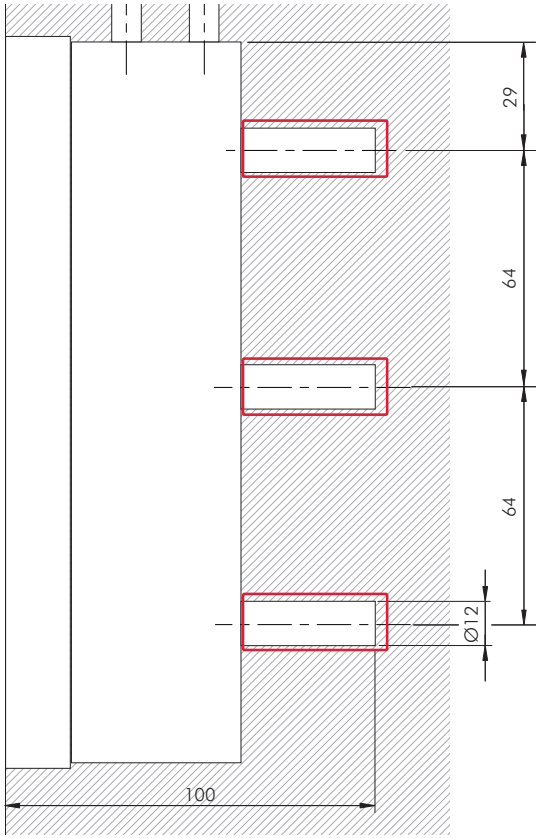





**DRILL BIT FOR LEVELLER Ø 14**

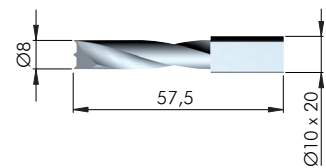
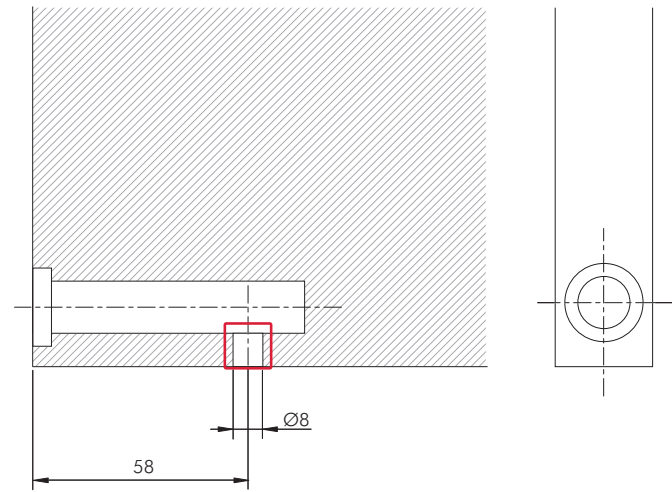
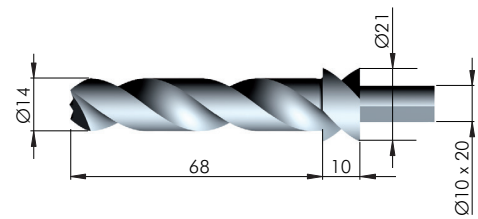
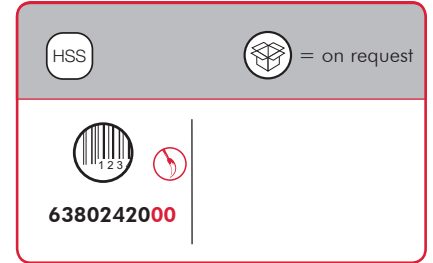
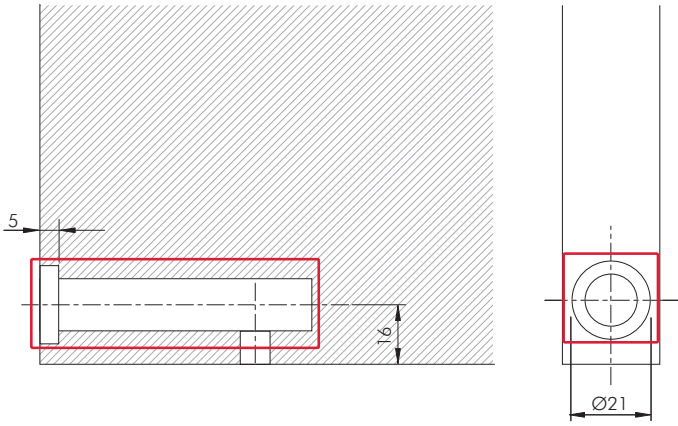

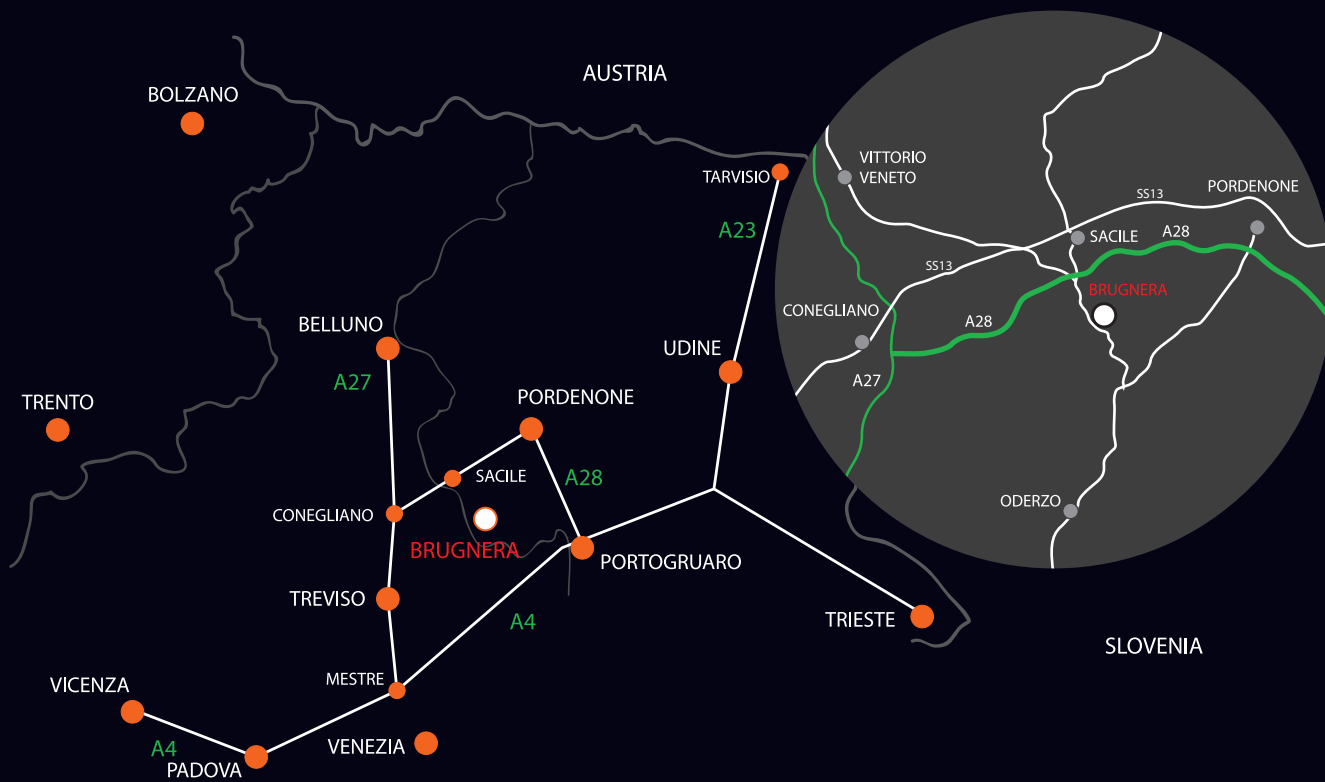

[www.italianaferramenta.com](http://www.italianaferramenta.com)